

The Building Society

Meeting & Venue hire



Welcome to The Building Society

A collaborative workspace to inspire ideas and action across the built environment



Formal Meeting Rooms

Ground Floor Overview

Large Formal Meeting Rooms

Small Formal Meeting Rooms

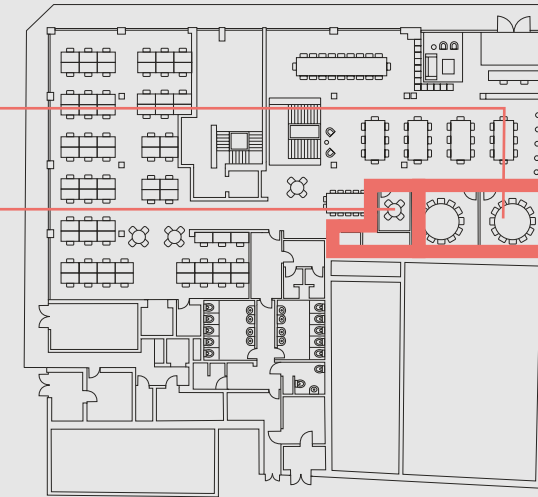

Pricing

Non-Members P/Hr

- Large Meeting: £70
- Medium Meeting: £45
- Small Meeting: £25

Members

- Discount applied to all rates

Spaces

Large

Room 1: 269 SqFt

Room 2: 291 SqFt

— Both capacity: x12 seated

Medium

Room 3: 100 SqFt

— Capacity: x4 seated

Small Booth

Rooms 4-5

— Capacity: x2 seated

Catering options available

Equipment

- TV Screens
- Video Call & Screen-share
- Zoom Conferencing
- Recording Technology
- Flip Charts

Usage

- Presentations
- Board Meetings
- Formal Meetings
- Design Reviews
- Project Reviews
- Video Conferences
- Training Sessions



Casual Meeting Space

Ground Floor Overview

Interactive Conference Table

Network Area

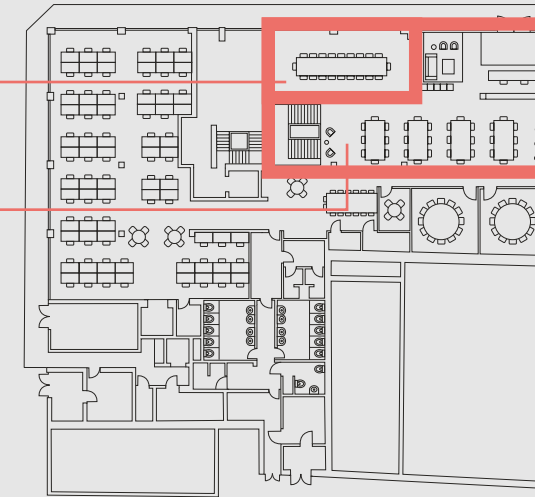

Pricing

Non-Members

- Hourly: £60
- Half-day (Mon-Fri): £220
- Full-day (Mon-Fri): £460

In addition, prices for full network area (weekends and evenings only)

- Half-day (W/end): £600
- Full-day (W/end): £1000
- Evening (18:00-23:00): £600

Members

- Discount applied to all rates

Spaces

Interactive Conference Table

- Capacity: x20 seated

Network Area 548 SqFt

- Capacity: x60 seated
Evening & Weekends only

In addition, you can hire out the area for an event which can hold up to 200 for a reception.

Catering options available

Equipment

- Interactive TV Screen
- Video Call & Screen-share
- Zoom Conferencing
- Recording Technology
- Flip Charts

Usage

- Informal Meetings
- Workshops & Reviews
- Training Sessions
- Project Reviews
- Catered Dinners
- Social Occasions



Conference & Events Space & Lounge Space

Lower Ground Overview

Lounge Space

Conference & Event Space

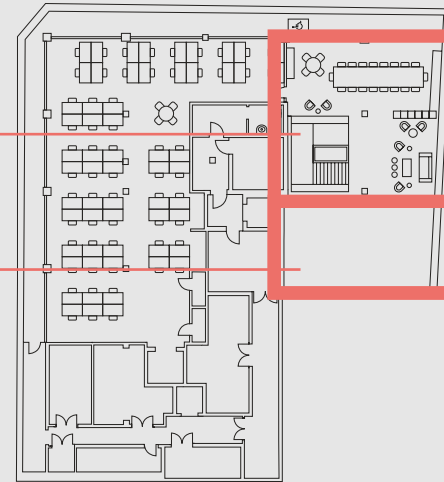

Pricing

Non-Members

- Hourly: £120
- Half-day (Mon-Fri): £460
- Full-day (Mon-Fri): £940
- Half-day (W/end): £600
- Full-day (W/end): £1000
- Evening (18:00-23:00): £600

Members

- Discount applied to all rates

Spaces

Conference & Events Space 687 SqFt

- Theatre: x80
- Reception: x120
- Classroom: x60
- Boardroom: x20
- U-Shape: x20

Downstairs Lounge Space 431 SqFt

In addition, our downstairs reception space adjacent to the conference room can also be booked at an extra charge and has the capacity for 120 people.

Catering options available

Equipment

- TV Screens
- AV Equipment
- Video Call & Screen-share
- Zoom Conferencing
- Microphones
- Recording Technology
- Flip Charts
- Sound System
- Dimable Lighting

Usage

- Training Sessions
- Conferences & Talks
- Presentations
- Workshops & Reviews
- Board Meetings
- Fitness Classes
- Parties & Social Occasions
- Design Team Meetings

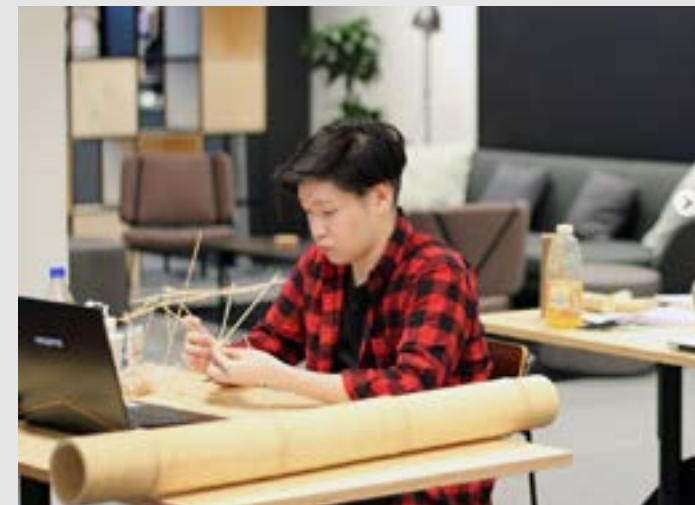
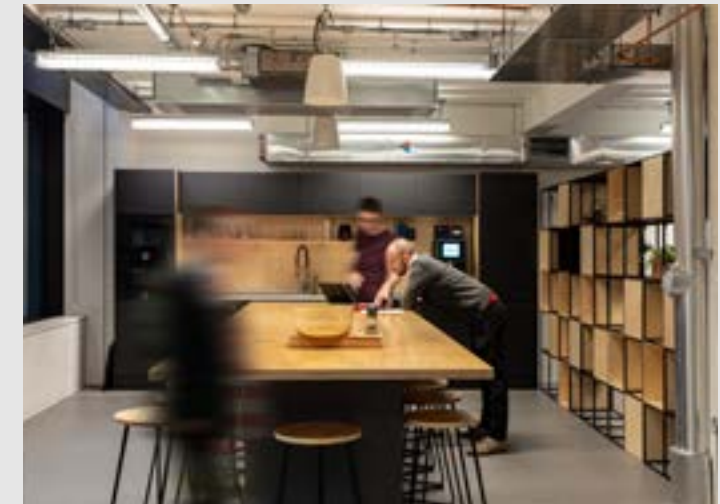

Costs & Conditions

Staff

Quoted and charged for events that are outside of normal office hours.

Cleaning

Quoted and charged depending on scale of the event.

Catering

We have a number of catering packages available depending on the event you are hosting. Please enquire for more detail.

- Meeting Package: £5pp
- Breakfast Package: £10pp
- Lunch Package: £12pp
- Premium Lunch Package: £20pp
- Dinner: Priced upon request
- Events: Priced upon request

*Dietary requirements
accomodated*

Deposits & Cancellation Fees

50% deposit is applicable to your booking upon confirmation.

Cancellation fees may apply, please enquire for more details.

Please note

Space capacities may vary due to Covid-19, please enquire for more details.

Location & Contact

Venue Hire & Memberships

+44 (0)207 499 5888
info@thebuildingsociety.org
thebuildingsociety.org

Address

The Building Society
5 Whitfield Street, Fitzrovia,
London, W1T 4AH
T +44 (0)207 499 5888
E info@thebuildingsociety.org
W thebuildingsociety.org

Connectivity

- Fifteen minutes walk King's Cross & Eurostar
- Ten minutes walk Euston
- Close by Victoria Line & Gatwick Express
- Close by to Central Line & The City
- Close by to Circle Line & Heathrow express

